

East 8th Street

Lot 47-1 Reserved

Mabel Street

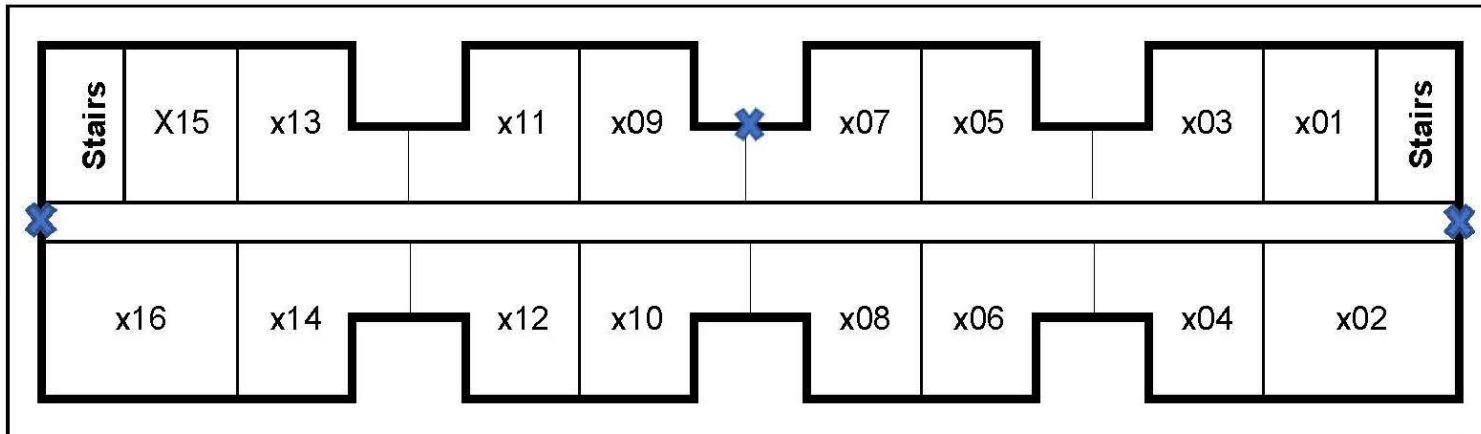

Douglas Street

Lot 47-1 Reserved

Dumpster

Decosimo Apartments

Lot 47-2
Reserved

MLK BLVD

 Entrance

Guerry Apartments

Map Description

General Description

This map shows the layout of the Guerry Apartments building. The building is a single, continuous structure with apartments arranged along two parallel interior corridors. Apartment units are labeled using stack identifiers and are accessed from shared interior hallways.

Spatial Organization

The building is rectangular in shape and extends between Mabel Street and Douglas Street, with East 8th Street located above the building and MLK Boulevard below. Apartment units are arranged in two long rows separated by a central hallway. Stairwells are located at both ends of the building, and entrances are marked along the corridor.

Labels and Notations

- Apartment stacks labeled x01 through x16.
- Entrances marked along the interior corridor.
- Stairs located at both ends of the building.
- Dumpster located near the lower-right corner of the site.
- Reserved parking areas labeled Lot 47-1 Reserved and Lot 47-2 Reserved.

Layout Summary

Apartment Units

- Along the upper corridor, apartment stacks progress from x15 and x13 near the left stairwell through x11, x09, x07, x05, x03, and x01 toward the right stairwell.
- Along the lower corridor, apartment stacks progress from x16 and x14 near the left side through x12, x10, x08, x06, x04, and x02 toward the right side.

Community Facilities

- No community rooms or shared interior facilities are labeled within this building.

Parking Areas

- Lot 47-1 Reserved is located above and below the building footprint.
- Lot 47-2 Reserved is located to the lower-right of the site.

Surrounding Landmarks

- Decosimo Apartments located to the right of the building.
- East 8th Street located above the building.
- MLK Boulevard located below the building.

Roads and Access

- Mabel Street runs along the left side of the building.
- Douglas Street runs along the right side.
- Entrances are marked along the central corridor.